

*Thank you for  
purchasing this Roller  
Blind! Please read the  
instruction carefully  
before use to ensure  
safe and satisfactory  
operation of this  
product.*



# **INSTRUCTIONAL MANUAL FOR ROLLER BLINDS**



**FURNISHED**

# ASSEMBLY ACCESSORIES

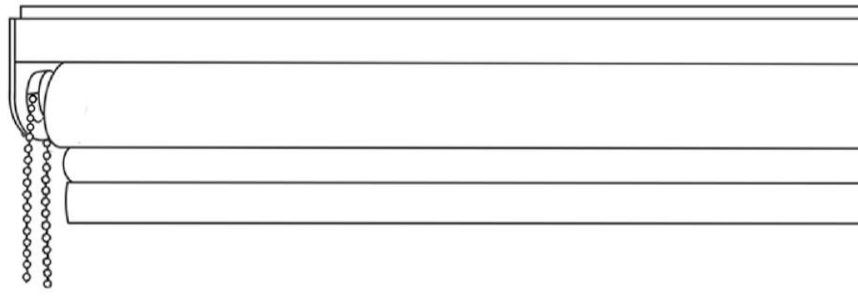

## Blind Fittings

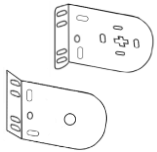

2x End  
Brackets



2x End Brackets  
Covers

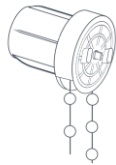

Winder with  
Chain

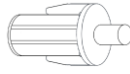

Pivot  
Roller

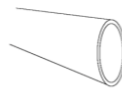

Bottom  
weight bar



P Clip

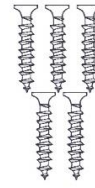

5x  
Screws

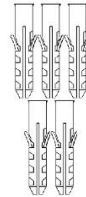

5x Wall  
plugs



Chain  
connector

## TOOLS REQUIRED FOR INSTALLATION



Drill bit

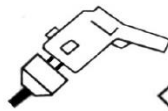

Drill

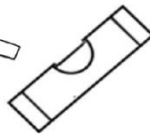

Leveler



Tape Measure



Screw Driver

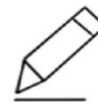

Pencil

## TOOLS TO ADJUST WIDTH (OPTIONAL)



Hack Saw



Scissors

# 01

## TO ADJUST BLIND WIDTH

01

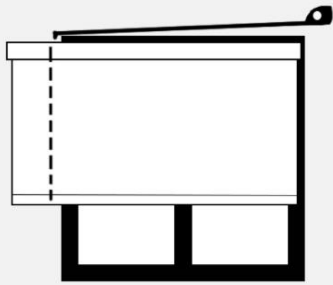

02

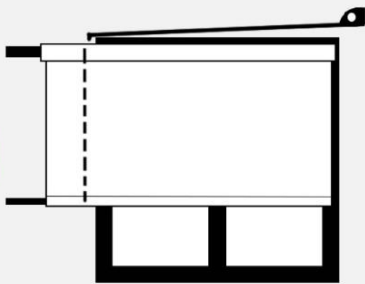

03

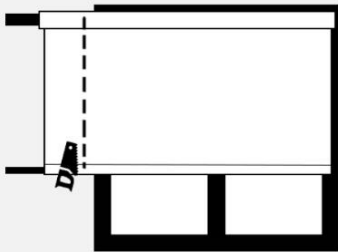

04

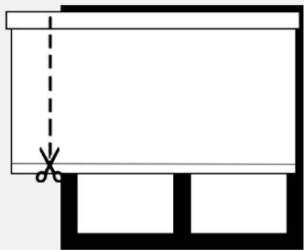

05

AND YOUR  
BLINDS IS READY  
FOR SETUP!

Decide which end you want to have the chain – the bracket instructions opposite are for installing *the blind with the chain to the right* – if you want to have the chain to the left simply flip the positions of your 2x bracket round.



# 02

## BLIND SETUP

Insert the *bottom weight bar*, the *winder with chain* and the *pivot roller* into the relevant parts of the blind as shown.



# 03

## INSTALL BLIND PARTS

Mount the brackets as desired. It may be wall fix (A), top fix (B) or recess side fix (C)

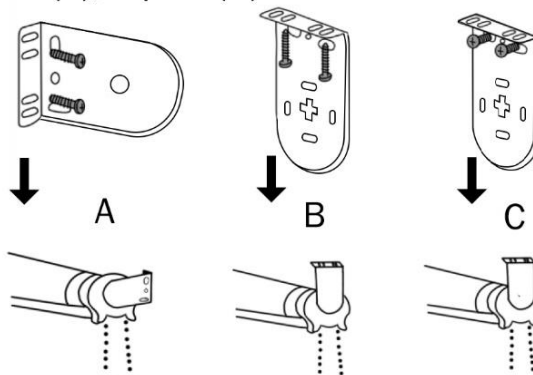

# 04

## BRACKET POSITIONING AND FIXING

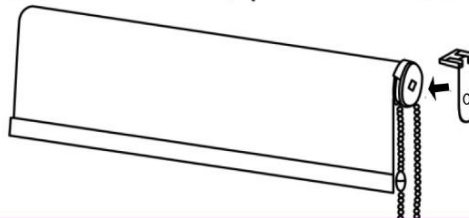

Slide the bracket covers in place as shown.

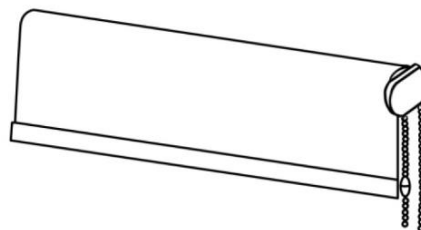

# 05

## INSERT BRACKET COVERS



# 06

## BLIND OPERATION

Pull on the chain loop to operate the blind. Always keep at least a full revolution of fabric on the roller.

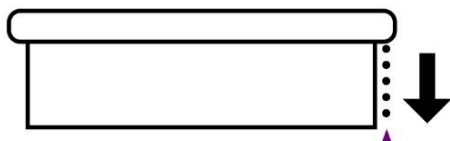

# 07

## FIT CHILD SAFETY DEVICE

The child safety P-clip is designed for fitting onto an adjacent surface to the blind in order to eliminate a hazardous cord.

1. Pull the chain up into the child safety clip.
2. Place the child safety clip onto an adjacent wall or where the clip is fixed in such a way that the loop cannot be easily reached.
3. Ensure the control chain is pulled tight. It must be installed at the maximum distance possible from the control mechanism to prevent the loop pull cord becoming slack.
4. Screw the child safety clip in place.

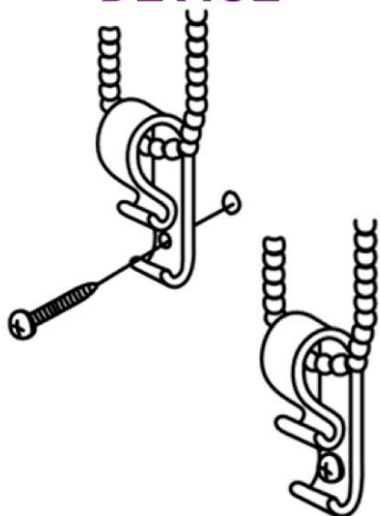

Children can be strangled if this safety device is not installed. Always use this device to keep cords or chains out of reach of children. Keep the instructions for future reference. Use of additional safety devices helps reduce the risk of strangulation but cannot be considered entirely foolproof.

**The Child Safety device reduces the hazards of strangulations or entanglement by limiting access to the cord or bead chain. Anchor the device with the cord or bead chain to the wall or floor, so that children cannot pull the cord or bead chain around their necks.**



## WARNING!

Please read all safety warnings and installation information fully before installation. Young children can be strangled by loops in pull cords, chains, tapes and inner cords that operate the product. To avoid strangulation and entanglement, keep cords out of the reach of young children.

All safety clips should be positioned high enough to be out of reach of small children yet accessible to adults. All safety clips for blinds need to be fixed to a solid surface using a screw and fixing suitable for the wall or surface material. These items should not be glued or stuck in place. Keep out of the reach of young children. Small parts may serve as choking hazards. For further information go to: [furnisheduk.com](http://furnisheduk.com)